

SMALL-SIGNAL TRANSFORMERS, CLASS 0.5... / 0.1 A

The small-signal transformer is a plug-in current transformer with very low secondary current. This makes it particularly safe if touched.



SMALL-SIGNAL TRANSFORMERS – TECHNICAL DATA

SMALL-SIGNAL TRANSFORMERS, CLASS 0.5 / 0.1 A SECONDARY CURRENT

TYPE	PRIMARY CURRENT in A	RATIO	POWER in VA	PRIMARY CONDUCTOR	ROUND CONDUCTOR in mm	WIDTH in mm	WEIGHT in kg	PART NO.
ASR 20.3	150	150/0.1	1.5	–	21	45	0.30	1503200
ASK 41.4	250	250/0.1	1.5	40 x 10; 2 x 30 x 5	32	71	0.36	1503210
ASK 41.4	400	400/0.1	1.5	40 x 10; 2 x 30 x 5	32	71	0.40	1503215
CTB 31.35	150	150/0.1	1.5	30 x 10; 25 x 12; 20 x 20	25.7	60	0.40	1503220
CTB 41.35	250	250/0.1	1.5	40 x 10; 30 x 15	31.8	70	0.40	1503225
CTB 41.35	400	400/0.1	1.5	40 x 10; 30 x 15	31.8	70	0.40	1503230

ACCESSORIES

Snap-on mounting for ASR 20.3	1502143
Snap-on mounting for ASK 41.4	1502142
Snap-on mounting for CTB	1502140

SINGLE ACCESSORIES (loads are included in the scope of delivery with the transformers)

Load (0.8 Ω) for operating current transformers with 1.5 m connection cable and spring terminal	1503085
---	-------------------------

SMALL-SIGNAL TRANSFORMERS – DIMENSIONAL DRAWINGS

ASR 20.3

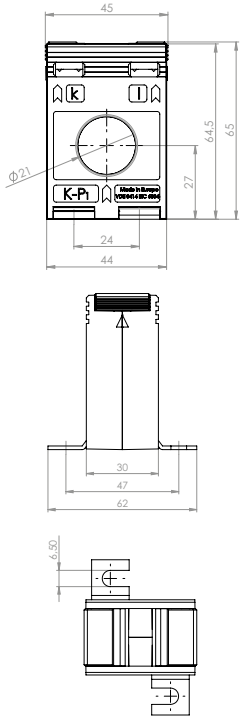

ASK 41.4

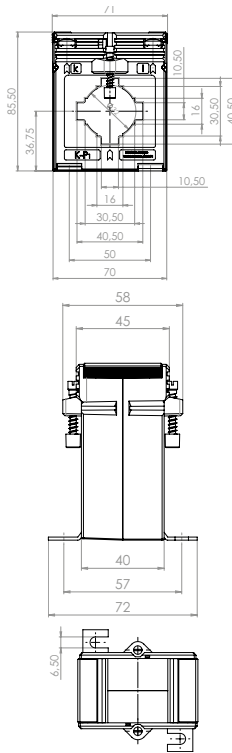

CTB 31.35

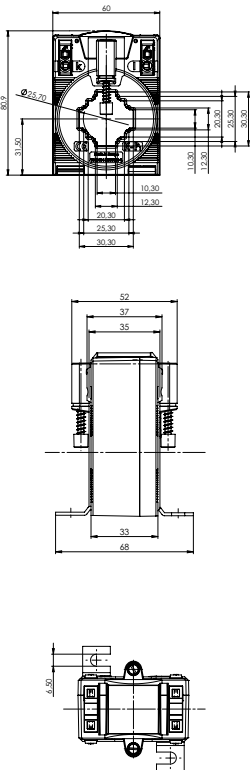

CTB 41.35

